

面積一覧表

地番名	地積
W189-1-1	191.83 m ²
W189-1-2	193.95 m ²
W189-1-3	198.94 m ²
W189-1-4	188.25 m ²
W189-1-5	188.50 m ²
W189-2-1	186.02 m ²
W189-2-2	230.32 m ²
W189-2-3	186.02 m ²
W189-2-4	230.32 m ²
W189-2-5	186.02 m ²
W189-2-6	230.32 m ²
W189-2-7	186.02 m ²
W189-2-8	230.32 m ²
W189-2-9	185.00 m ²
W189-2-10	185.00 m ²
W189-2-11	185.00 m ²
W189-2-12	186.00 m ²
W189-2-13	186.00 m ²
W189-2-14	186.00 m ²
W189-2-15	186.00 m ²
W189-2-16	186.00 m ²
W189-2-17	186.00 m ²
合計	4296.83 m ²

座 標 一 覧 表

測 点 名	X 座 標	Y 座 標
W189-1	-97804.104	-2153.897
W189-2	-97803.929	-2156.899
W189-3	-97830.362	-2184.202
W189-4	-97833.301	-2184.816
W189-5	-97916.053	-2135.207
W189-6	-97916.796	-2132.294
W189-7	-97898.051	-2100.705
W189-8	-97895.129	-2100.007
W189-21	-97848.360	-2175.788
W189-24	-97827.082	-2140.294
W189-30	-97859.163	-2169.312
W189-31	-97869.966	-2162.836
W189-32	-97880.769	-2156.359
W189-33	-97891.572	-2149.883
W189-34	-97902.376	-2143.407
W189-35	-97912.595	-2125.215
W189-36	-97907.391	-2116.445
W189-37	-97902.200	-2107.697
W189-38	-97881.275	-2108.209
W189-39	-97878.694	-2109.738
W189-40	-97867.660	-2116.270
W189-41	-97865.078	-2117.798
W189-42	-97854.090	-2124.304
W189-43	-97851.508	-2125.832
W189-44	-97840.564	-2132.312
W189-45	-97837.982	-2133.840
W189-46	-97834.650	-2152.919
W189-47	-97840.767	-2163.123
W189-48	-97845.515	-2146.405

測 点 名	X 座 標	Y 座 標
W189-49	-97848.102	-2144.886
W189-50	-97859.010	-2138.347
W189-51	-97861.598	-2136.828
W189-52	-97872.550	-2130.262
W189-53	-97875.138	-2128.743
W189-54	-97886.135	-2122.151
W189-55	-97886.582	-2117.061
W189-56	-97891.812	-2125.785
W189-57	-97897.055	-2134.531
W189-58	-97851.570	-2156.646
W189-59	-97854.205	-2155.067
W189-60	-97862.373	-2150.170
W189-61	-97867.687	-2146.985
W189-62	-97873.177	-2143.694
W189-63	-97881.212	-2138.876
W189-64	-97883.980	-2137.217

測 点 名	X 座 標	Y 座 標
W189-65	-97894.783	-2130.741
W189-66	-97843.475	-2167.639
W189-67	-97838.944	-2160.081
W189-68	-97834.537	-2152.730
W189-69	-97825.781	-2178.246
W189-70	-97819.902	-2171.497
W189-71	-97813.677	-2165.235
W189-72	-97815.600	-2147.091
W189-73	-97823.094	-2159.590
W189-C1	-97805.890	-2158.449
W189-C2	-97807.823	-2160.035
W189-C3	-97809.725	-2161.657
W189-C4	-97811.597	-2163.314
W189-C5	-97813.437	-2165.006
W189-C6	-97815.246	-2166.732
W189-C7	-97817.022	-2168.491

測 点 名	X 座 標	Y 座 標
W189-C8	-97818.765	-2170.283
W189-C9	-97820.474	-2172.108
W189-C10	-97822.150	-2173.963
W189-C11	-97823.790	-2175.850
W189-C12	-97825.395	-2177.767
W189-C13	-97826.963	-2179.713
W189-C14	-97828.496	-2181.689
W189-C15	-97829.991	-2183.692

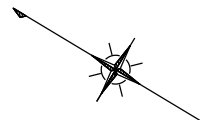
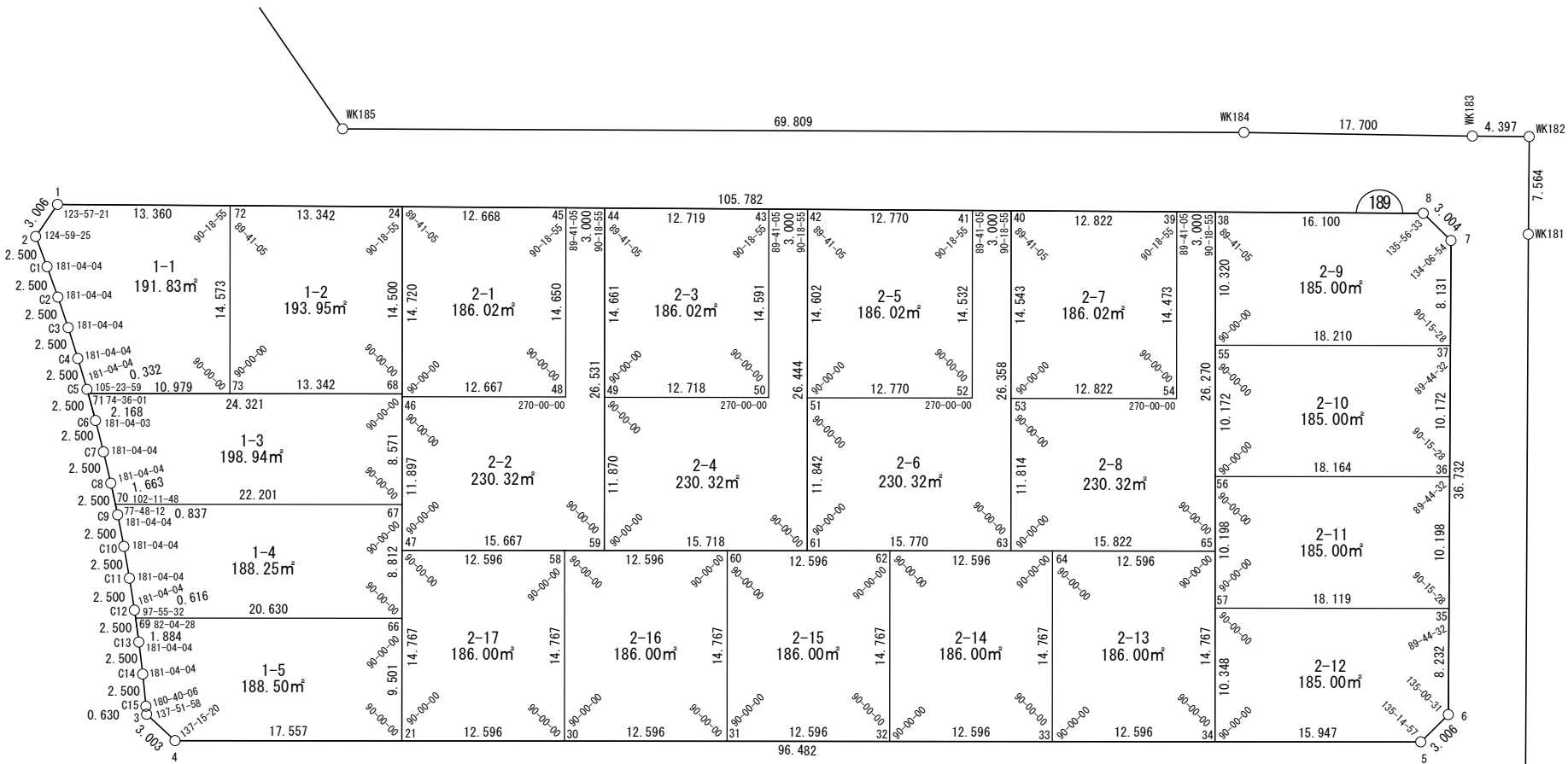

世界測地系

面積（座標法）計算書

地 番： W189-1-1

測点名	[1] X(i)	[2] X(i+1)-X(i-1)	[3] Y(i)	[4] Y(i+1)-Y(i-1)	[2]*[3]	[1]*[4]	方向角	夾 角	距 離
W189-1	-97804.104	11.671	-2153.897	-9.808	-25138.665284	959223.007857	273-19-44	123-57-21	3.006
W189-2	-97803.929	-1.787	-2156.899	-4.551	3853.998255	445133.339965	218-19-09	124-59-25	2.500
W189-C1	-97805.890	-3.894	-2158.449	-3.136	8404.057546	306762.453672	219-23-13	181-04-04	2.500
W189-C2	-97807.823	-3.834	-2160.035	-3.208	8282.526182	313811.782262	220-27-17	181-04-04	2.500
W189-C3	-97809.725	-3.774	-2161.657	-3.279	8158.063451	320752.311456	221-31-21	181-04-04	2.500
W189-C4	-97811.597	-3.712	-2163.314	-3.349	8030.699731	327581.610378	222-35-25	181-04-04	2.500
W189-C5	-97813.437	-2.081	-2165.006	-1.921	4504.627525	187899.814196	223-39-29	181-04-04	0.332
W189-71	-97813.677	-9.656	-2165.235	5.416	20908.456723	-529737.277763	149-03-28	105-23-59	10.979
W189-73	-97823.094	-1.923	-2159.590	18.144	4152.984263	-1774940.179683	59-03-28	90-00-00	14.573
W189-72	-97815.600	18.990	-2147.091	5.693	-40773.088392	-556870.522345	329-22-23	90-18-55	13.360
合計				倍面積 面積	383.660004 191.8300020	-383.660004 191.8300020			54.750

面積（座標法）計算書

地番：W189-1-2

測点名	[1] X(i)	[2] X(i+1)-X(i-1)	[3] Y(i)	[4] Y(i+1)-Y(i-1)	[2]*[3]	[1]*[4]	方向角	夾角	距離
W189-73	-97823.094	-18.937	-2159.590	-5.639	40895.662120	551646.740490	149-03-28	90-00-00	13.342
W189-68	-97834.537	-3.988	-2152.730	19.297	8585.127175	-1887886.196838	59-03-28	90-00-00	14.500
W189-24	-97827.082	18.937	-2140.294	5.639	-40530.244507	-551669.229834	329-22-23	90-18-55	13.342
W189-72	-97815.600	3.988	-2147.091	-19.297	-8562.637830	1887520.779225	239-03-28	89-41-05	14.573
合計				倍面積	387.906957	-387.906957			55.757
				面積	193.9534790	193.9534790			

面積（座標法）計算書

地 番： W189-1-3

測点名	[1] X(i)	[2] X(i+1)-X(i-1)	[3] Y(i)	[4] Y(i+1)-Y(i-1)	[2]*[3]	[1]*[4]	方向角	夾 角	距 離
W189-70	-97819.902	-20.179	-2171.497	10.202	43818.599858	-997951.905424	149-03-28	102-11-48	22.201
W189-67	-97838.944	-14.635	-2160.081	18.767	31612.719152	-1836104.859667	59-03-28	90-00-00	8.571
W189-68	-97834.537	25.267	-2152.730	-5.154	-54392.546153	504231.475366	329-03-28	90-00-00	24.321
W189-71	-97813.677	19.291	-2165.235	-14.002	-41770.200031	1369573.519372	223-39-29	74-36-01	2.168
W189-C6	-97815.246	-3.345	-2166.732	-3.256	7247.061752	318482.414013	224-43-32	181-04-03	2.500
W189-C7	-97817.022	-3.519	-2168.491	-3.551	7631.521022	347378.480114	225-47-36	181-04-04	2.500
W189-C8	-97818.765	-2.880	-2170.283	-3.005	6250.735243	293992.985380	226-51-40	181-04-04	1.663
合計				倍面積	397.890844	-397.890844			63.924
				面 積	198.9454222	198.9454222			

面積（座標法）計算書

地 番： W189-1-4

測点名	[1] X(i)	[2] X(i+1)-X(i-1)	[3] Y(i)	[4] Y(i+1)-Y(i-1)	[2]*[3]	[1]*[4]	方向角	夾 角	距 離
W189-69	-97825.781	-18.080	-2178.246	10.128	39383.443176	-990732.099330	149-03-28	97-55-32	20.630
W189-66	-97843.475	-13.163	-2167.639	18.165	28532.387611	-1777336.667116	59-03-28	90-00-00	8.812
W189-67	-97838.944	23.573	-2160.081	-3.857	-50919.185272	377406.361396	329-03-28	90-00-00	22.201
W189-70	-97819.902	18.470	-2171.497	-12.026	-40106.653506	1176397.152176	226-51-40	77-48-12	0.837
W189-C9	-97820.474	-2.247	-2172.108	-2.467	4881.691998	241278.790053	227-55-44	181-04-04	2.500
W189-C10	-97822.150	-3.315	-2173.963	-3.742	7207.418590	366090.864494	228-59-48	181-04-04	2.500
W189-C11	-97823.790	-3.245	-2175.850	-3.804	7060.678806	372077.059227	230-03-52	181-04-04	2.500
W189-C12	-97825.395	-1.991	-2177.767	-2.397	4336.735957	234442.021735	231-07-56	181-04-04	0.616
合計				倍面積	376.517362	-376.517362			60.596
				面 積	188.2586812	188.2586812			

面積（座標法）計算書

地 番： W189-1-5

測点名	[1] X(i)	[2] X(i+1)-X(i-1)	[3] Y(i)	[4] Y(i+1)-Y(i-1)	[2]*[3]	[1]*[4]	方向角	夾 角	距 離
W189-3	-97830.362	-3.311	-2184.202	-1.124	7230.802584	109913.047175	191-48-08	137-51-58	3.003
W189-4	-97833.301	-17.998	-2184.816	8.413	39323.209139	-823099.504592	149-03-28	137-15-20	17.557
W189-21	-97848.360	-10.174	-2175.788	17.176	22135.680301	-1680683.837721	59-03-28	90-00-00	9.501
W189-66	-97843.475	22.579	-2167.639	-2.458	-48942.925960	240525.836251	329-03-28	90-00-00	20.630
W189-69	-97825.781	16.512	-2178.246	-12.074	-35966.232296	1181146.352947	231-07-56	82-04-28	1.884
W189-C13	-97826.963	-2.714	-2179.713	-3.442	5916.736222	336737.751817	232-12-00	181-04-04	2.500
W189-C14	-97828.496	-3.027	-2181.689	-3.979	6604.874825	389252.559818	233-16-04	181-04-04	2.500
W189-C15	-97829.991	-1.866	-2183.692	-2.513	4074.858377	245830.791108	233-56-10	180-40-06	0.630
合計				倍面積	377.003194	-377.003194			58.205
				面 積	188.5015970	188.5015970			

面積（座標法）計算書

地 番： W189-2-1

測点名	[1] X(i)	[2] X(i+1)-X(i-1)	[3] Y(i)	[4] Y(i+1)-Y(i-1)	[2]*[3]	[1]*[4]	方向角	夾 角	距 離
W189-24	-97827.082	3.332	-2140.294	-19.078	-7131.420791	1866393.926256	239-03-28	89-41-05	14.720
W189-46	-97834.650	-18.433	-2152.919	-6.112	39685.232535	597948.250431	149-03-28	90-00-00	12.667
W189-48	-97845.515	-3.332	-2146.405	19.078	7151.785284	-1866745.604509	59-03-28	90-00-00	14.650
W189-45	-97837.982	18.433	-2133.840	6.112	-39333.554282	-597968.614924	329-22-23	90-18-55	12.668
合計				倍面積	372.042745	-372.042745			54.705
				面 積	186.0213730	186.0213730			

面積（座標法）計算書

地 番： W189-2-2

測点名	[1] X(i)	[2] X(i+1)-X(i-1)	[3] Y(i)	[4] Y(i+1)-Y(i-1)	[2]*[3]	[1]*[4]	方向角	夾 角	距 離
W189-44	-97840.564	16.223	-2132.312	21.227	-34592.313438	-2076837.535828	329-22-23	90-18-55	3.000
W189-45	-97837.982	-4.951	-2133.840	-14.094	10564.972964	1378892.563706	239-03-28	89-41-05	14.650
W189-48	-97845.515	3.332	-2146.405	-19.078	-7151.785284	1866745.604509	329-03-28	270-00-00	12.667
W189-46	-97834.650	4.748	-2152.919	-16.717	-10221.061427	1635523.173314	239-03-28	90-00-00	11.897
W189-47	-97840.767	-19.555	-2163.123	-2.148	42299.642002	210186.829343	149-03-28	90-00-00	15.667
W189-59	-97854.205	0.204	-2155.067	30.811	-438.809562	-3014971.280299	59-03-28	90-00-00	26.531
合計				倍面積	460.645253	-460.645253			84.412
				面 積	230.3226270	230.3226270			

面積（座標法）計算書

地番：W189-2-3

測点名	[1] X(i)	[2] X(i+1)-X(i-1)	[3] Y(i)	[4] Y(i+1)-Y(i-1)	[2]*[3]	[1]*[4]	方向角	夾角	距離
W189-43	-97851.508	18.447	-2125.832	6.035	-39214.790092	-590547.100334	329-22-23	90-18-55	12.719
W189-44	-97840.564	3.406	-2132.312	-19.054	-7262.998096	1864262.532875	239-03-28	89-41-05	14.661
W189-49	-97848.102	-18.447	-2144.886	-6.035	39566.276877	590526.543690	149-03-28	90-00-00	12.718
W189-50	-97859.010	-3.406	-2138.347	19.054	7283.554741	-1864614.019661	59-03-28	90-00-00	14.591
合計				倍面積	372.043430	-372.043430			54.689
				面積	186.0217152	186.0217152			

面積（座標法）計算書

地 番： W189-2-4

測点名	[1] X(i)	[2] X(i+1)-X(i-1)	[3] Y(i)	[4] Y(i+1)-Y(i-1)	[2]*[3]	[1]*[4]	方向角	夾 角	距 離
W189-42	-97854.090	16.178	-2124.304	21.153	-34367.945143	-2069866.566761	329-22-23	90-18-55	3.000
W189-43	-97851.508	-4.921	-2125.832	-14.043	10460.748572	1374124.882351	239-03-28	89-41-05	14.591
W189-50	-97859.010	3.406	-2138.347	-19.054	-7283.554741	1864614.019661	329-03-28	270-00-00	12.718
W189-49	-97848.102	4.805	-2144.886	-16.720	-10307.095768	1636017.915664	239-03-28	90-00-00	11.870
W189-59	-97854.205	-19.585	-2155.067	-2.098	42206.147434	205346.550084	149-03-28	90-00-00	15.718
W189-61	-97867.687	0.115	-2146.985	30.763	-247.655788	-3010697.445565	59-03-28	90-00-00	26.444
合計				倍面積	460.644565	-460.644565			84.341
				面 積	230.3222825	230.3222825			

面積（座標法）計算書

地 番： W189-2-5

測点名	[1] X(i)	[2] X(i+1)-X(i-1)	[3] Y(i)	[4] Y(i+1)-Y(i-1)	[2]*[3]	[1]*[4]	方向角	夾 角	距 離
W189-41	-97865.078	18.461	-2117.798	5.958	-39096.040009	-583083.298569	329-22-23	90-18-55	12.770
W189-42	-97854.090	3.481	-2124.304	-19.030	-7394.417221	1862141.200755	239-03-28	89-41-05	14.602
W189-51	-97861.598	-18.461	-2136.828	-5.958	39447.342968	583062.559459	149-03-28	90-00-00	12.770
W189-52	-97872.550	-3.481	-2130.262	19.030	7415.156332	-1862492.503714	59-03-28	90-00-00	14.532
合計				倍面積	372.042069	-372.042069			54.674
				面 積	186.0210347	186.0210347			

面積（座標法）計算書

地 番： W189-2-6

測点名	[1] X(i)	[2] X(i+1)-X(i-1)	[3] Y(i)	[4] Y(i+1)-Y(i-1)	[2]*[3]	[1]*[4]	方向角	夾 角	距 離
W189-40	-97867.660	16.134	-2116.270	21.078	-34143.556749	-2062870.715415	329-22-23	90-18-55	3.000
W189-41	-97865.078	-4.890	-2117.798	-13.992	10356.682067	1369341.027645	239-03-28	89-41-05	14.532
W189-52	-97872.550	3.481	-2130.262	-19.030	-7415.156332	1862492.503714	329-03-28	270-00-00	12.770
W189-51	-97861.598	4.864	-2136.828	-16.723	-10393.104296	1636530.366258	239-03-28	90-00-00	11.842
W189-61	-97867.687	-19.615	-2146.985	-2.048	42112.474732	200471.327417	149-03-28	90-00-00	15.770
W189-63	-97881.212	0.027	-2138.876	30.715	-56.693486	-3006425.155553	59-03-28	90-00-00	26.358
合計				倍面積	460.645934	-460.645934			84.272
				面 積	230.3229671	230.3229671			

面積（座標法）計算書

地番：W189-2-7

測点名	[1] X(i)	[2] X(i+1)-X(i-1)	[3] Y(i)	[4] Y(i+1)-Y(i-1)	[2]*[3]	[1]*[4]	方向角	夾角	距離
W189-39	-97878.694	18.475	-2109.738	5.881	-38977.620881	-575590.447966	329-22-23	90-18-55	12.822
W189-40	-97867.660	3.556	-2116.270	-19.006	-7525.563567	1860049.727856	239-03-28	89-41-05	14.543
W189-53	-97875.138	-18.475	-2128.743	-5.881	39328.754353	575569.536071	149-03-28	90-00-00	12.822
W189-54	-97886.135	-3.556	-2122.151	19.006	7546.475461	-1860400.861328	59-03-28	90-00-00	14.473
合計				倍面積	372.045366	-372.045366			54.660
				面積	186.0226832	186.0226832			

面積（座標法）計算書

地 番： W189-2-8

測点名	[1] X(i)	[2] X(i+1)-X(i-1)	[3] Y(i)	[4] Y(i+1)-Y(i-1)	[2]*[3]	[1]*[4]	方向角	夾 角	距 離
W189-38	-97881.275	16.089	-2108.209	21.004	-33919.146415	-2055849.698173	329-22-23	90-18-55	3.000
W189-39	-97878.694	-4.860	-2109.738	-13.941	10252.990227	1364557.515147	239-03-28	89-41-05	14.473
W189-54	-97886.135	3.556	-2122.151	-19.006	-7546.475461	1860400.861328	329-03-28	270-00-00	12.822
W189-53	-97875.138	4.923	-2128.743	-16.726	-10479.407948	1637047.034637	239-03-28	90-00-00	11.814
W189-63	-97881.212	-19.645	-2138.876	-1.998	42018.506710	195541.076044	149-03-28	90-00-00	15.822
W189-65	-97894.783	-0.063	-2130.741	30.667	134.178521	-3002157.434618	59-03-28	90-00-00	26.270
合計				倍面積	460.645633	-460.645633			84.201
				面 積	230.3228168	230.3228168			

面積（座標法）計算書

地 番： W189-2-9

測点名	[1] X(i)	[2] X(i+1)-X(i-1)	[3] Y(i)	[4] Y(i+1)-Y(i-1)	[2]*[3]	[1]*[4]	方向角	夾 角	距 離
W189-37	-97902.200	-11.469	-2107.697	16.356	24174.005238	-1601253.514126	59-18-56	90-15-28	8.131
W189-7	-97898.051	7.071	-2100.705	7.690	-14854.127301	-752853.153766	13-25-50	134-06-54	3.004
W189-8	-97895.129	16.776	-2100.007	-7.504	-35229.029537	734630.375027	329-22-23	135-56-33	16.100
W189-38	-97881.275	8.548	-2108.209	-17.053	-18020.222879	1669202.901925	239-03-28	89-41-05	10.320
W189-55	-97886.582	-20.925	-2117.061	0.512	44299.375480	-50096.610061	149-03-28	90-00-00	18.210
合計				倍面積	370.001000	-370.001000			55.765
				面 積	185.0005004	185.0005004			

面積（座標法）計算書

地番：W189-2-10

測点名	[1] X(i)	[2] X(i+1)-X(i-1)	[3] Y(i)	[4] Y(i+1)-Y(i-1)	[2]*[3]	[1]*[4]	方向角	夾角	距離
W189-36	-97907.391	-10.389	-2116.445	18.088	21986.787170	-1770900.935636	59-18-56	90-15-28	10.172
W189-37	-97902.200	20.810	-2107.697	-0.615	-43860.266015	60240.476946	329-03-28	89-44-32	18.210
W189-55	-97886.582	10.389	-2117.061	-18.088	-21993.179374	1770524.542431	239-03-28	90-00-00	10.172
W189-56	-97891.812	-20.810	-2125.785	0.615	44236.659220	-60234.084742	149-03-28	90-00-00	18.164
合計				倍面積	370.001000	-370.001000			56.718
				面積	185.0005001	185.0005001			

面積（座標法）計算書

地 番： W189-2-11

測点名	[1] X(i)	[2] X(i+1)-X(i-1)	[3] Y(i)	[4] Y(i+1)-Y(i-1)	[2]*[3]	[1]*[4]	方向角	夾 角	距 離
W189-35	-97912.595	-10.336	-2125.215	18.086	21966.491704	-1770848.830587	59-18-56	90-15-28	10.198
W189-36	-97907.391	20.783	-2116.445	-0.570	-43987.025408	55780.161129	329-03-28	89-44-32	18.164
W189-56	-97891.812	10.336	-2125.785	-18.086	-21972.380440	1770472.940852	239-03-28	90-00-00	10.198
W189-57	-97897.055	-20.783	-2134.531	0.570	44362.915143	-55774.272393	149-03-28	90-00-00	18.119
合計				倍面積	370.000999	-370.000999			56.679
				面 積	185.0004997	185.0004997			

面積（座標法）計算書

地番：W189-2-12

測点名	[1] X(i)	[2] X(i+1)-X(i-1)	[3] Y(i)	[4] Y(i+1)-Y(i-1)	[2]*[3]	[1]*[4]	方向角	夾角	距離
W189-57	-97897.055	10.220	-2134.531	-18.191	-21813.869821	1780882.528384	239-03-28	90-00-00	10.348
W189-34	-97902.376	-18.998	-2143.407	-0.676	40720.095017	66181.301017	149-03-28	90-00-00	15.947
W189-5	-97916.053	-14.420	-2135.207	11.112	30789.983912	-1088078.918508	104-18-25	135-14-57	3.006
W189-6	-97916.796	3.458	-2132.294	9.992	-7372.862295	-978392.211696	59-18-56	135-00-31	8.232
W189-35	-97912.595	19.741	-2125.215	-2.237	-41953.345814	219037.299804	329-03-28	89-44-32	18.119
合計				倍面積	370.000998	-370.000998			55.652
				面積	185.0004995	185.0004995			

面積（座標法）計算書

地番：W189-2-13

測点名	[1] X(i)	[2] X(i+1)-X(i-1)	[3] Y(i)	[4] Y(i+1)-Y(i-1)	[2]*[3]	[1]*[4]	方向角	夾角	距離
W189-33	-97891.572	-18.396	-2149.883	-6.189	39549.070878	605871.293838	149-03-28	90-00-00	12.596
W189-34	-97902.376	-3.210	-2143.407	19.142	6881.012436	-1874031.423597	59-03-28	90-00-00	14.767
W189-65	-97894.783	18.396	-2130.741	6.189	-39196.939192	-605891.163150	329-03-28	90-00-00	12.596
W189-64	-97883.980	3.210	-2137.217	-19.142	-6861.143123	1873679.291911	239-03-28	90-00-00	14.767
合計				倍面積	372.000998	-372.000998			54.726
				面積	186.0004993	186.0004993			

面積（座標法）計算書

地番：W189-2-14

測点名	[1] X(i)	[2] X(i+1)-X(i-1)	[3] Y(i)	[4] Y(i+1)-Y(i-1)	[2]*[3]	[1]*[4]	方向角	夾角	距離
W189-32	-97880.769	-18.396	-2156.359	-6.189	39668.208642	605804.431101	149-03-28	90-00-00	12.596
W189-33	-97891.572	-3.210	-2149.883	19.142	6901.803453	-1873824.641869	59-03-28	90-00-00	14.767
W189-64	-97883.980	18.396	-2137.217	6.189	-39316.076955	-605824.300413	329-03-28	90-00-00	12.596
W189-62	-97873.177	3.210	-2143.694	-19.142	-6881.934140	1873472.510181	239-03-28	90-00-00	14.767
合計				倍面積	372.001000	-372.001000			54.726
				面積	186.0005002	186.0005002			

面積（座標法）計算書

地 番： W189-2-15

測点名	[1] X(i)	[2] X(i+1)-X(i-1)	[3] Y(i)	[4] Y(i+1)-Y(i-1)	[2]*[3]	[1]*[4]	方向角	夾 角	距 離
W189-31	-97869.966	-18.396	-2162.836	-6.189	39787.346404	605737.578150	149-03-28	90-00-00	12.596
W189-32	-97880.769	-3.210	-2156.359	19.142	6922.594471	-1873617.850351	59-03-28	90-00-00	14.767
W189-62	-97873.177	18.396	-2143.694	6.189	-39435.214717	-605757.447463	329-03-28	90-00-00	12.596
W189-60	-97862.373	3.210	-2150.170	-19.142	-6902.725158	1873265.718664	239-03-28	90-00-00	14.767
合計				倍面積	372.001000	-372.001000			54.726
				面 積	186.0005003	186.0005003			

面積（座標法）計算書

地 番： W189-2-16

測点名	[1] X(i)	[2] X(i+1)-X(i-1)	[3] Y(i)	[4] Y(i+1)-Y(i-1)	[2]*[3]	[1]*[4]	方向角	夾 角	距 離
W189-30	-97859.163	-18.396	-2169.312	-6.189	39906.484167	605670.715412	149-03-28	90-00-00	12.596
W189-31	-97869.966	-3.210	-2162.836	19.142	6943.385488	-1873411.058834	59-03-28	90-00-00	14.767
W189-60	-97862.373	18.396	-2150.170	6.189	-39554.352479	-605690.584725	329-03-28	90-00-00	12.596
W189-58	-97851.570	3.210	-2156.646	-19.142	-6923.516175	1873058.927146	239-03-28	90-00-00	14.767
合計				倍面積	372.001000	-372.001000			54.726
				面 積	186.0005003	186.0005003			

面積（座標法）計算書

地番：W189-2-17

測点名	[1] X(i)	[2] X(i+1)-X(i-1)	[3] Y(i)	[4] Y(i+1)-Y(i-1)	[2]*[3]	[1]*[4]	方向角	夾角	距離
W189-58	-97851.570	18.396	-2156.646	6.189	-39673.490241	-605623.721987	329-03-28	90-00-00	12.596
W189-47	-97840.767	3.210	-2163.123	-19.142	-6944.307192	1872852.135628	239-03-28	90-00-00	14.767
W189-21	-97848.360	-18.396	-2175.788	-6.189	40025.621929	605603.852674	149-03-28	90-00-00	12.596
W189-30	-97859.163	-3.210	-2169.312	19.142	6964.176505	-1873204.267316	59-03-28	90-00-00	14.767
合計				倍面積	372.001000	-372.001000			54.726
				面積	186.0005003	186.0005003			