

豊田浄水特定土地区画整理事業 画地出来形確認測量原図 縮尺=1：1000 158、251BLOCK

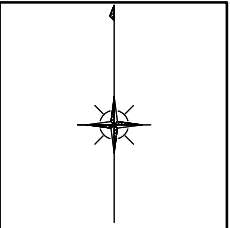

世界測地系

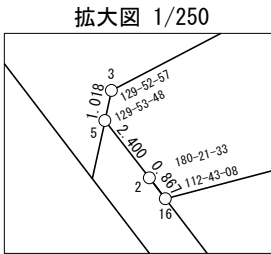

座 標 一 覧 表

測 点 名	X 座 標	Y 座 標
W152-5	-97181.027	-3207.530
W155-2	-97096.726	-3530.031
W155-16	-97097.415	-3529.504
W155-25	-97236.169	-3268.370
W155-26	-97201.361	-3384.413
W155-27	-97185.102	-3407.998
W155-28	-97109.939	-3466.108
W155-29	-97084.285	-3479.509
W158-1	-97063.959	-3469.506
W158-2	-97063.072	-3472.371
W158-3	-97093.835	-3531.285
W158-5	-97094.829	-3531.502
W158-8	-97187.957	-3365.390
W158-9	-97162.575	-3402.247
W158-10	-97099.078	-3451.154
W158-11	-97219.646	-3265.446
W158-12	-97236.855	-3263.256
W158-16	-97235.289	-3268.484
W158-18	-97217.358	-3267.387
W158-21	-97189.908	-3365.975
W158-22	-97191.340	-3361.172
W158-23	-97189.397	-3360.590
W158-C53	-97187.344	-3367.293
W158-C54	-97186.682	-3369.181
W158-C55	-97185.972	-3371.050
W158-C56	-97185.215	-3372.902
W158-C57	-97184.414	-3374.734
W158-C58	-97183.555	-3376.540
W158-C59	-97182.638	-3378.318
W158-C60	-97181.694	-3380.081
W158-C61	-97180.699	-3381.816
W158-C62	-97179.653	-3383.521
W158-C63	-97178.557	-3385.194
W158-C64	-97177.419	-3386.838
W158-C65	-97176.238	-3388.453
W158-C66	-97175.017	-3390.037
W158-C67	-97173.737	-3391.573
W158-C68	-97172.416	-3393.075
W158-C69	-97171.055	-3394.540
W158-C70	-97169.671	-3395.984
W158-C71	-97168.245	-3397.387
W158-C72	-97166.779	-3398.748
W158-C73	-97165.275	-3400.066
W158-C74	-97163.733	-3401.339
W251-6	-97179.303	-3213.279
W251-13	-97228.639	-3246.252

測 点 名	X 座 標	Y 座 標
W251-14	-97233.477	-3252.595
W251-15	-97221.992	-3254.061
W251-17	-97215.594	-3251.221
W251-C1	-97226.959	-3244.268
W251-C2	-97225.234	-3242.323
W251-C3	-97223.484	-3240.400
W251-C4	-97221.715	-3238.495
W251-C5	-97219.914	-3236.619
W251-C6	-97218.083	-3234.773
W251-C7	-97216.221	-3232.958
W251-C8	-97214.330	-3231.174
W251-C9	-97212.409	-3229.422
W251-C10	-97210.460	-3227.701
W251-C11	-97208.482	-3226.013
W251-C12	-97206.477	-3224.357
W251-C13	-97204.445	-3222.735
W251-C14	-97202.387	-3221.147
W251-C15	-97200.302	-3219.592
W251-C16	-97198.193	-3218.073
W251-C17	-97196.058	-3216.588
W251-C18	-97193.899	-3215.139
W251-C19	-97191.717	-3213.726
W251-C20	-97189.511	-3212.349

測 点 名	X 座 標	Y 座 標
W251-C21	-97187.283	-3211.009
W251-C22	-97185.034	-3209.705
W251-C23	-97182.763	-3208.439
W251-C30	-97180.131	-3213.908
W251-C31	-97182.185	-3215.502
W251-C32	-97184.213	-3217.129
W251-C33	-97186.214	-3218.789
W251-C34	-97188.189	-3220.479
W251-C35	-97190.137	-3222.202
W251-C36	-97192.057	-3223.955
W251-C37	-97193.949	-3225.738
W251-C38	-97195.812	-3227.552
W251-C39	-97197.646	-3229.394
W251-C40	-97199.451	-3231.266
W251-C41	-97201.225	-3233.167

測 点 名	X 座 標	Y 座 標
W251-C42	-97202.969	-3235.095
W251-C43	-97204.689	-3237.045
W251-C44	-97206.363	-3239.035
W251-C45	-97208.012	-3241.044
W251-C46	-97209.630	-3243.080
W251-C47	-97211.214	-3245.141
W251-C48	-97212.766	-3247.228
W251-C49	-97214.284	-3249.339

面積一覧表

地番名	面積
14号緑地	630.63 m ²
合計	630.63 m ²

地番名	面積
2号緑地	5680.60 m ²
1	10.18 m ²
合計	5690.78 m ²

拡大図 1/250

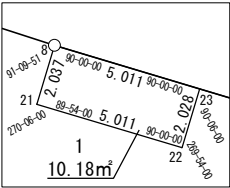

拡大図 1/500

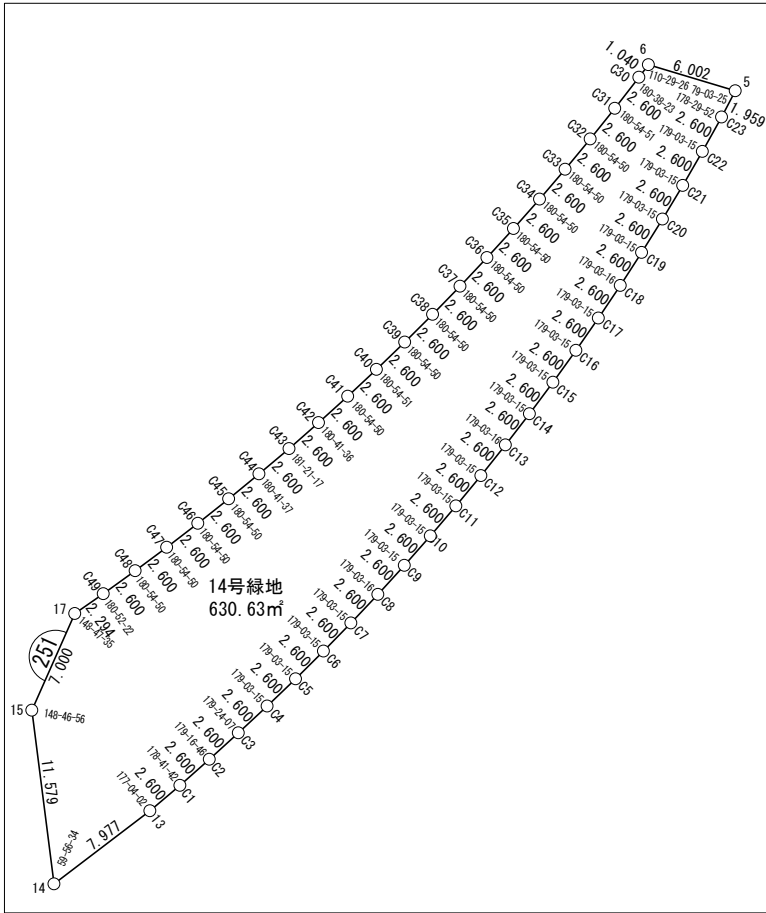

豊田浄水特定土地区画整理組合

株式会社 オオバ 名古屋支店

面積（座標法）計算書

地 番： W158-1(ゴミ置場)

測点名	[1] X(i)	[2] X(i+1)-X(i-1)	[3] Y(i)	[4] Y(i+1)-Y(i-1)	[2]*[3]	[1]*[4]	方向角	夾 角	距 離
W158-8	-97187.957	-0.511	-3365.390	-5.385	1719.510460	523369.483311	196-41-58	90-00-00	2.037
W158-21	-97189.908	-3.383	-3365.975	4.217	11385.410921	-409857.608480	106-35-58	89-54-00	5.011
W158-22	-97191.340	0.511	-3361.172	5.385	-1717.355788	-523387.698504	16-41-58	90-06-00	2.028
W158-23	-97189.397	3.383	-3360.590	-4.217	-11367.195728	409855.453808	286-41-58	90-00-00	5.011
合計				倍面積	20.369866	-20.369866			14.087
				面 積	10.1849330	10.1849330			

面積（座標法）計算書

地番：W158-2号緑地

測点名	[1] X(i)	[2] X(i+1)-X(i-1)	[3] Y(i)	[4] Y(i+1)-Y(i-1)	[2]*[3]	[1]*[4]	方向角	夾角	距離
W158-1	-97063.959	36.006	-3469.506	-21.217	-124923.209503	2059424.847761	287-11-47	134-47-08	3.000
W158-2	-97063.072	-29.876	-3472.371	-61.779	103741.563834	5996489.694999	242-25-39	135-13-52	66.462
W158-3	-97093.835	-31.758	-3531.285	-59.130	112145.851809	5741203.002186	192-18-36	129-52-57	1.018
W158-5	-97094.829	-2.891	-3531.502	1.254	10210.692588	-121744.769474	142-12-24	129-53-48	2.400
W155-2	-97096.726	-2.585	-3530.031	1.998	9126.354348	-194003.438124	142-33-57	180-21-33	0.867
W155-16	-97097.415	12.441	-3529.504	50.522	-43912.085622	-4905514.417326	75-17-05	112-43-08	51.690
W155-29	-97084.285	-12.524	-3479.509	63.396	43578.001053	-6154722.467826	152-25-06	257-08-01	28.944
W155-28	-97109.939	-100.818	-3466.108	71.512	349444.651024	-6944491.117460	142-17-30	169-52-24	95.007
W155-27	-97185.102	-91.422	-3407.998	81.695	311566.459034	-7939533.323604	124-34-54	162-17-24	28.646
W155-26	-97201.361	-51.067	-3384.413	139.627	172830.654323	-13571965.688839	106-41-49	162-06-55	121.151
W155-25	-97236.169	-33.928	-3268.370	115.930	110890.472791	-11272546.112833	352-39-52	65-58-03	0.887
W158-16	-97235.289	-0.686	-3268.484	5.115	2242.157586	-497330.423789	106-40-13	294-00-21	5.457
W158-12	-97236.855	15.644	-3263.256	3.038	-51049.479608	-295422.639995	352-44-54	66-04-41	17.348
W158-11	-97219.646	19.496	-3265.446	-4.131	-63664.711802	401652.913638	319-40-21	146-55-27	3.000
W158-18	-97217.358	30.248	-3267.387	-95.144	-98833.216634	9249667.977716	286-41-58	147-01-37	97.306
W158-23	-97189.397	26.019	-3360.590	-93.785	-87437.844669	9114939.541915	196-41-58	90-00-00	2.028
W158-22	-97191.340	-0.511	-3361.172	-5.385	1717.355788	523387.698504	286-35-58	269-54-00	5.011
W158-21	-97189.908	3.383	-3365.975	-4.217	-11385.410921	409857.608480	16-41-58	270-06-00	2.037
W158-8	-97187.957	2.564	-3365.390	-1.318	-8630.312689	128126.839682	287-51-49	91-09-51	2.000
W158-C53	-97187.344	1.275	-3367.293	-3.791	-4294.608688	368435.062780	289-19-30	181-27-41	2.000
W158-C54	-97186.682	1.372	-3369.181	-3.757	-4621.357378	365151.589580	290-47-11	181-27-41	2.000
W158-C55	-97185.972	1.467	-3371.050	-3.721	-4945.435781	361630.430974	292-14-52	181-27-41	2.000
W158-C56	-97185.215	1.558	-3372.902	-3.684	-5253.881732	358031.206352	293-35-29	181-20-37	2.000
W158-C57	-97184.414	1.660	-3374.734	-3.639	-5600.725092	353646.513582	295-26-28	181-50-59	2.000
W158-C58	-97183.555	1.776	-3376.540	-3.583	-5997.401405	348253.110938	297-17-27	181-50-59	2.000
W158-C59	-97182.638	1.861	-3378.318	-3.541	-6287.673531	344078.512753	298-10-08	180-52-41	2.000
W158-C60	-97181.694	1.939	-3380.081	-3.498	-6555.633661	339933.373576	299-50-42	181-40-34	2.000
W158-C61	-97180.699	2.041	-3381.816	-3.440	-6902.187607	334271.565251	301-31-16	181-40-34	2.000

面積（座標法）計算書

地 番： W158-2号緑地

測点名	[1] X(i)	[2] X(i+1)-X(i-1)	[3] Y(i)	[4] Y(i+1)-Y(i-1)	[2]*[3]	[1]*[4]	方向角	夾 角	距 離
W158-C62	-97179.653	2.142	-3383.521	-3.378	-7245.919889	328272.946043	303-13-31	181-42-15	2.000
W158-C63	-97178.557	2.234	-3385.194	-3.317	-7563.831296	322386.831699	304-41-49	181-28-18	2.000
W158-C64	-97177.419	2.319	-3386.838	-3.259	-7853.564954	316700.342832	306-10-07	181-28-18	2.000
W158-C65	-97176.238	2.402	-3388.453	-3.198	-8138.321500	310804.933964	307-38-25	181-28-18	2.000
W158-C66	-97175.017	2.501	-3390.037	-3.121	-8479.996045	303238.955027	309-47-30	182-09-05	2.000
W158-C67	-97173.737	2.601	-3391.573	-3.038	-8821.854605	295253.566638	311-20-26	181-32-56	2.000
W158-C68	-97172.416	2.682	-3393.075	-2.967	-9101.219816	288309.236313	312-53-22	181-32-56	2.000
W158-C69	-97171.055	2.745	-3394.540	-2.909	-9319.056627	282680.013881	313-47-31	180-54-09	2.000
W158-C70	-97169.671	2.810	-3395.984	-2.847	-9541.259639	276607.877492	315-27-24	181-39-53	2.000
W158-C71	-97168.245	2.891	-3397.387	-2.764	-9822.130392	268556.083283	317-07-18	181-39-54	2.000
W158-C72	-97166.779	2.970	-3398.748	-2.679	-10094.810352	260277.737161	318-47-11	181-39-53	2.000
W158-C73	-97165.275	3.047	-3400.066	-2.591	-10359.048965	251779.829599	320-27-04	181-39-53	2.000
W158-C74	-97163.733	2.700	-3401.339	-2.181	-9183.239098	211952.247607	321-53-44	181-26-40	1.471
W158-9	-97162.575	64.655	-3402.247	-49.815	-219972.694059	4840167.618631	322-23-44	180-30-00	80.149
W158-10	-97099.078	98.617	-3451.154	-67.259	-340340.880482	6530743.478300	332-24-39	190-00-55	39.625
合計				倍面積 面積	11361.210124 5680.6050621	-11361.210124 5680.6050621			697.504

面 積 (座 標 法) 計 算 書

地 番 : W251-14号緑地

測点名	[1] X(i)	[2] X(i+1)-X(i-1)	[3] Y(i)	[4] Y(i+1)-Y(i-1)	[2]*[3]	[1]*[4]	方向角	夾 角	距 離
W251-17	-97215.594	-7.708	-3251.221	-4.723	25060.297905	459145.129869	203-56-36	148-47-35	7.000
W251-15	-97221.992	-17.883	-3254.061	-1.375	58191.818347	133639.871901	172-43-32	148-46-56	11.579
W251-14	-97233.477	-6.648	-3252.595	7.809	21622.383244	-759324.760797	52-40-06	59-56-34	7.977
W251-13	-97228.639	6.518	-3246.252	8.327	-21159.678422	-809638.796184	49-44-08	177-04-02	2.600
W251-C1	-97226.959	3.406	-3244.268	3.929	-11048.647980	-382022.144689	48-25-50	178-41-42	2.600
W251-C2	-97225.234	3.475	-3242.323	3.869	-11265.982352	-376120.211374	47-42-36	179-16-46	2.600
W251-C3	-97223.484	3.519	-3240.400	3.828	-11403.045767	-372208.053784	47-06-43	179-24-07	2.600
W251-C4	-97221.715	3.570	-3238.495	3.781	-11562.266193	-367555.578616	46-09-58	179-03-15	2.600
W251-C5	-97219.914	3.632	-3236.619	3.721	-11755.971693	-361769.367724	45-13-13	179-03-15	2.600
W251-C6	-97218.083	3.693	-3234.773	3.661	-11946.354548	-355884.689050	44-16-28	179-03-15	2.600
W251-C7	-97216.221	3.753	-3232.958	3.599	-12133.372966	-349903.159600	43-19-43	179-03-15	2.600
W251-C8	-97214.330	3.812	-3231.174	3.537	-12316.988095	-343826.406068	42-22-59	179-03-16	2.600
W251-C9	-97212.409	3.870	-3229.422	3.473	-12497.161091	-337656.113427	41-26-14	179-03-15	2.600
W251-C10	-97210.460	3.927	-3227.701	3.409	-12673.852784	-331393.976304	40-29-29	179-03-15	2.600
W251-C11	-97208.482	3.982	-3226.013	3.344	-12847.026571	-325041.689252	39-32-44	179-03-15	2.600
W251-C12	-97206.477	4.037	-3224.357	3.278	-13016.646460	-318601.005054	38-35-59	179-03-15	2.600
W251-C13	-97204.445	4.091	-3222.735	3.210	-13182.676731	-312073.695823	37-39-15	179-03-16	2.600
W251-C14	-97202.387	4.143	-3221.147	3.143	-13345.083215	-305461.543271	36-42-30	179-03-15	2.600
W251-C15	-97200.302	4.194	-3219.592	3.074	-13503.831987	-298766.358132	35-45-45	179-03-15	2.600
W251-C16	-97198.193	4.244	-3218.073	3.004	-13658.890318	-291989.980148	34-49-00	179-03-15	2.600
W251-C17	-97196.058	4.293	-3216.588	2.934	-13810.226661	-285134.268332	33-52-15	179-03-15	2.600
W251-C18	-97193.899	4.341	-3215.139	2.862	-13957.810310	-278201.091236	32-55-31	179-03-16	2.600
W251-C19	-97191.717	4.388	-3213.726	2.790	-14101.611069	-271192.365812	31-58-46	179-03-15	2.600
W251-C20	-97189.511	4.433	-3212.349	2.717	-14241.599880	-264109.999085	31-02-01	179-03-15	2.600
W251-C21	-97187.283	4.478	-3211.009	2.644	-14377.748483	-256955.917293	30-05-16	179-03-15	2.600
W251-C22	-97185.034	4.521	-3209.705	2.570	-14510.029730	-249732.114470	29-08-31	179-03-15	2.600
W251-C23	-97182.763	4.007	-3208.439	2.175	-12854.995559	-211381.789779	27-38-23	178-29-52	1.959
W152-5	-97181.027	3.460	-3207.530	-4.840	-11098.526589	470378.745832	286-41-48	79-03-25	6.002

面積（座標法）計算書

地 番： W251-14号緑地

測点名	[1] X(i)	[2] X(i+1)-X(i-1)	[3] Y(i)	[4] Y(i+1)-Y(i-1)	[2]*[3]	[1]*[4]	方向角	夾 角	距 離
W251-6	-97179.303	0.896	-3213.279	-6.378	-2878.905326	619785.714588	217-11-14	110-29-26	1.040
W251-C30	-97180.131	-2.882	-3213.908	-2.223	9262.988016	216042.121160	217-49-37	180-38-23	2.600
W251-C31	-97182.185	-4.082	-3215.502	-3.222	13124.274431	313079.793820	218-44-28	180-54-51	2.600
W251-C32	-97184.213	-4.030	-3217.129	-3.286	12963.933194	319373.368047	219-39-18	180-54-50	2.600
W251-C33	-97186.214	-3.977	-3218.789	-3.350	12800.250672	325585.869153	220-34-08	180-54-50	2.600
W251-C34	-97188.189	-3.923	-3220.479	-3.413	12633.258479	331715.701190	221-28-58	180-54-50	2.600
W251-C35	-97190.137	-3.868	-3222.202	-3.475	12462.989152	337761.277832	222-23-48	180-54-50	2.600
W251-C36	-97192.057	-3.812	-3223.955	-3.537	12289.475197	343721.061260	223-18-38	180-54-50	2.600
W251-C37	-97193.949	-3.755	-3225.738	-3.597	12112.751039	349593.523307	224-13-28	180-54-50	2.600
W251-C38	-97195.812	-3.697	-3227.552	-3.656	11932.851423	355377.164903	225-08-18	180-54-50	2.600
W251-C39	-97197.646	-3.638	-3229.394	-3.715	11749.811424	361070.506372	226-03-08	180-54-50	2.600
W251-C40	-97199.451	-3.579	-3231.266	-3.772	11563.667109	366672.087446	226-57-59	180-54-51	2.600
W251-C41	-97201.225	-3.518	-3233.167	-3.829	11374.455873	372180.457556	227-52-49	180-54-50	2.600
W251-C42	-97202.969	-3.464	-3235.095	-3.878	11206.724240	376959.722350	228-34-25	180-41-36	2.600
W251-C43	-97204.689	-3.394	-3237.045	-3.939	10986.963225	382911.996559	229-55-42	181-21-17	2.600
W251-C44	-97206.363	-3.323	-3239.035	-3.999	10764.265520	388766.874708	230-37-19	180-41-37	2.600
W251-C45	-97208.012	-3.267	-3241.044	-4.045	10587.711316	393254.070955	231-32-09	180-54-50	2.600
W251-C46	-97209.630	-3.202	-3243.080	-4.097	10383.748939	398275.745790	232-26-59	180-54-50	2.600
W251-C47	-97211.214	-3.136	-3245.141	-4.148	10176.959084	403196.118960	233-21-49	180-54-50	2.600
W251-C48	-97212.766	-3.070	-3247.228	-4.197	9967.383971	408013.944262	234-16-39	180-54-50	2.600
W251-C49	-97214.284	-2.829	-3249.339	-3.993	9191.242362	388182.934102	235-09-01	180-52-22	2.294
合計				倍面積 面 積	1261.273380 630.6366901	-1261.273380 630.6366901			147.051