

世界測地系

地番	面積
W11-1	142.25㎡
W11-2	341.31㎡
W11-3	268.38㎡
W11-4	49.59㎡
W11-5	212.81㎡
W11-6	264.48㎡
W11-7	183.56㎡
W11-8	282.89㎡
W11-9	413.26㎡
合計	2158.53㎡

座標一覧表		
測点名	X座標	Y座標
W11-1	-97350.212	-1802.670
W11-2	-97352.337	-1795.575
W11-3	-97346.634	-1785.016
W11-4	-97289.607	-1768.066
W11-5	-97242.134	-1752.382
W11-6	-97228.569	-1748.343
W11-7	-97225.930	-1749.783
W11-21	-97229.553	-1766.936
W11-22	-97248.373	-1772.462
W11-23	-97263.650	-1776.953
W11-26	-97294.983	-1786.220
W11-27	-97306.079	-1789.502
W11-28	-97323.175	-1794.598
W11-29	-97327.594	-1779.357

測点名	X座標	Y座標
W11-30	-97310.494	-1774.274
W11-31	-97299.402	-1770.977
W11-34	-97268.270	-1761.017
W11-35	-97253.141	-1756.018
W11-36	-97234.437	-1750.090
W11-37	-97279.051	-1781.508
W11-38	-97283.530	-1766.058
W11-39	-97266.524	-1777.803
W11-40	-97271.118	-1761.957
WK258	-97221.672	-1764.473
WK259	-97226.920	-1766.163
WK260	-97261.259	-1776.246
WK261	-97309.214	-1790.430

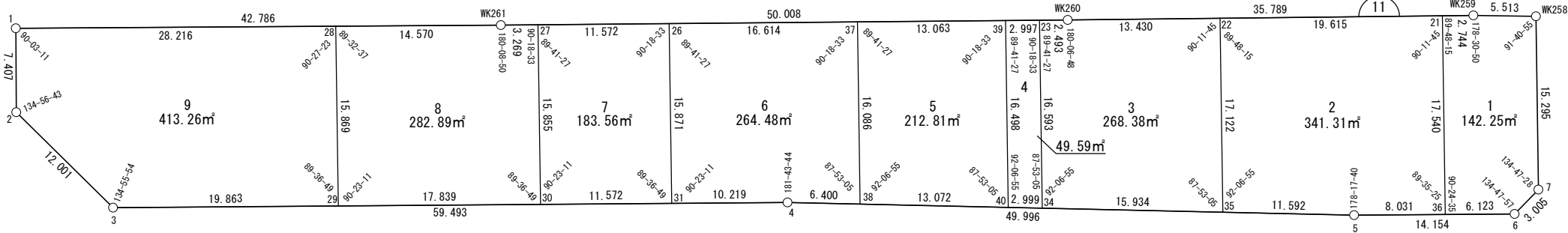

株式会社
オオバ
名古屋支店

豊田浄水特定土地区画整理組合

面積（座標法）計算書

地番：W11-1

測点名	[1] X(i)	[2] X(i+1)-X(i-1)	[3] Y(i)	[4] Y(i+1)-Y(i-1)	[2]*[3]	[1]*[4]	方向角	夾角	距離
W11-7	-97225.930	6.897	-1749.783	-16.130	-12068.220720	1568235.016635	286-10-03	134-47-28	15.295
WK258	-97221.672	-0.989	-1764.473	-16.380	1745.535247	1592489.541981	197-50-58	91-40-55	5.513
WK259	-97226.920	-7.881	-1766.163	-2.463	13919.710440	239483.089985	196-21-48	178-30-50	2.744
W11-21	-97229.553	-7.517	-1766.936	16.073	13282.291437	-1562762.589443	106-10-03	89-48-15	17.540
W11-36	-97234.437	0.984	-1750.090	18.593	-1722.695949	-1807873.828850	16-34-38	90-24-35	6.123
W11-6	-97228.569	8.506	-1748.343	0.307	-14872.104455	-29855.746308	331-22-35	134-47-57	3.005
合計				倍面積	284.516000	-284.516000			50.220
				面積	142.2580000	142.2580000			

面積（座標法）計算書

地番：W11-2

測点名	[1] X(i)	[2] X(i+1)-X(i-1)	[3] Y(i)	[4] Y(i+1)-Y(i-1)	[2]*[3]	[1]*[4]	方向角	夾角	距離
W11-21	-97229.553	-13.936	-1766.936	-22.372	24624.523747	2175224.941588	196-21-48	90-11-45	19.615
W11-22	-97248.373	-23.588	-1772.462	10.918	41808.122107	-1061798.779139	106-10-03	89-48-15	17.122
W11-35	-97253.141	6.239	-1756.018	20.081	-10955.731778	-1952913.745346	18-16-58	92-06-55	11.592
W11-5	-97242.134	18.704	-1752.382	5.928	-32776.035709	-576419.035042	16-34-38	178-17-40	8.031
W11-36	-97234.437	12.581	-1750.090	-14.555	-22018.242365	1415223.981937	286-10-03	89-35-25	17.540
合計				倍面積	682.636001	-682.636001			73.900
				面積	341.3180007	341.3180007			

面積（座標法）計算書

地番：W11-3

測点名	[1] X(i)	[2] X(i+1)-X(i-1)	[3] Y(i)	[4] Y(i+1)-Y(i-1)	[2]*[3]	[1]*[4]	方向角	夾角	距離
W11-34	-97268.270	10.510	-1761.017	20.935	-18507.549401	-2036326.791914	18-16-58	92-06-55	15.934
W11-35	-97253.141	19.897	-1756.018	-11.446	-34939.839564	1113134.958120	286-10-03	87-53-05	17.122
W11-22	-97248.373	-8.119	-1772.462	-20.228	14390.065268	1967140.129945	196-21-48	90-11-45	13.430
WK260	-97261.259	-15.277	-1776.246	-4.491	27135.726356	436778.139556	196-28-36	180-06-48	2.493
W11-23	-97263.650	-7.011	-1776.953	15.229	12458.372144	-1481263.210511	106-10-03	89-41-27	16.593
合計				倍面積	536.774802	-536.774802			65.572
				面積	268.3874014	268.3874014			

面積（座標法）計算書

地番：W11-4

測点名	[1] X(i)	[2] X(i+1)-X(i-1)	[3] Y(i)	[4] Y(i+1)-Y(i-1)	[2]*[3]	[1]*[4]	方向角	夾角	距離
W11-34	-97268.270	7.468	-1761.017	-14.996	-13151.328872	1458599.743537	286-10-03	87-53-05	16.593
W11-23	-97263.650	1.746	-1776.953	-16.787	-3102.609030	1632727.553264	196-28-36	90-18-33	2.997
W11-39	-97266.524	-7.468	-1777.803	14.996	13276.691870	-1458573.560740	106-10-03	89-41-27	16.498
W11-40	-97271.118	-1.746	-1761.957	16.787	3076.426232	-1632852.916262	18-16-58	92-06-55	2.999
合計				倍面積	99.180200	-99.180200			39.087
				面積	49.5901001	49.5901001			

面積（座標法）計算書

地番：W11-5

測点名	[1] X(i)	[2] X(i+1)-X(i-1)	[3] Y(i)	[4] Y(i+1)-Y(i-1)	[2]*[3]	[1]*[4]	方向角	夾角	距離
W11-39	-97266.524	-7.932	-1777.803	-19.551	14102.413293	1901626.435173	196-28-36	90-18-33	13.063
W11-37	-97279.051	-17.006	-1781.508	11.745	30295.478819	-1142553.906993	106-10-03	89-41-27	16.086
W11-38	-97283.530	7.932	-1766.058	19.551	-14009.245212	-1901958.904692	18-16-58	92-06-55	13.072
W11-40	-97271.118	17.006	-1761.957	-11.745	-29963.009300	1142460.738912	286-10-03	87-53-05	16.498
合計				倍面積	425.637599	-425.637599			58.719
				面積	212.8187996	212.8187996			

面積（座標法）計算書

地番：W11-6

測点名	[1] X(i)	[2] X(i+1)-X(i-1)	[3] Y(i)	[4] Y(i+1)-Y(i-1)	[2]*[3]	[1]*[4]	方向角	夾角	距離
W11-26	-97294.983	-20.351	-1786.220	10.531	36351.579365	-1024606.470676	106-10-03	89-41-27	15.871
W11-31	-97299.402	5.376	-1770.977	18.155	-9520.910921	-1766434.715902	16-33-14	90-23-11	10.219
W11-4	-97289.607	15.872	-1768.066	4.919	-28062.663591	-478580.552225	18-16-58	181-43-44	6.400
W11-38	-97283.530	10.556	-1766.058	-13.442	-18642.273982	1307725.361053	286-10-03	87-53-05	16.086
W11-37	-97279.051	-11.453	-1781.508	-20.162	20403.229330	1961367.417551	196-28-36	90-18-33	16.614
合計				倍面積	528.960200	-528.960200			65.190
				面積	264.4801001	264.4801001			

面積（座標法）計算書

地番：W11-7

測点名	[1] X(i)	[2] X(i+1)-X(i-1)	[3] Y(i)	[4] Y(i+1)-Y(i-1)	[2]*[3]	[1]*[4]	方向角	夾角	距離
W11-26	-97294.983	-6.678	-1786.220	-18.525	11927.564954	1802412.971220	196-28-36	90-18-33	11.572
W11-27	-97306.079	-15.512	-1789.502	11.946	27757.968637	-1162429.010196	106-10-03	89-41-27	15.855
W11-30	-97310.494	6.678	-1774.274	18.525	-11847.794285	-1802700.326551	16-33-14	90-23-11	11.572
W11-31	-97299.402	15.512	-1770.977	-11.946	-27470.613306	1162349.239527	286-10-03	89-36-49	15.871
合計				倍面積	367.126000	-367.126000			54.870
				面積	183.5630001	183.5630001			

面積（座標法）計算書

地番：W11-8

測点名	[1] X(i)	[2] X(i+1)-X(i-1)	[3] Y(i)	[4] Y(i+1)-Y(i-1)	[2]*[3]	[1]*[4]	方向角	夾角	距離
W11-27	-97306.079	1.280	-1789.502	-16.155	-2290.901271	1572013.223274	196-28-36	90-18-33	3.269
WK261	-97309.214	-17.096	-1790.430	-5.095	30608.895850	495834.730495	196-37-26	180-08-50	14.570
W11-28	-97323.175	-18.380	-1794.598	11.073	32984.279969	-1077636.618155	106-10-03	89-32-37	15.869
W11-29	-97327.594	12.681	-1779.357	20.324	-22564.021516	-1978052.767472	16-33-14	90-23-11	17.839
W11-30	-97310.494	21.514	-1774.274	-10.146	-38172.467033	987275.645859	286-10-03	89-36-49	15.855
合計				倍面積	565.785998	-565.785998			67.402
				面積	282.8929991	282.8929991			

面積（座標法）計算書

地番：W11-9

測点名	[1] X(i)	[2] X(i+1)-X(i-1)	[3] Y(i)	[4] Y(i+1)-Y(i-1)	[2]*[3]	[1]*[4]	方向角	夾角	距離
W11-28	-97323.175	-22.618	-1794.598	-23.313	40590.334591	2268920.252432	196-37-26	90-27-23	28.216
W11-1	-97350.212	-29.162	-1802.670	-0.977	52569.810349	95105.160134	106-40-37	90-03-11	7.407
W11-2	-97352.337	3.578	-1795.575	17.654	-6425.032875	-1718655.573655	61-37-20	134-56-43	12.001
W11-3	-97346.634	24.744	-1785.016	16.218	-44167.757707	-1578769.367027	16-33-14	134-55-54	19.863
W11-29	-97327.594	23.458	-1779.357	-9.582	-41740.828359	932573.002116	286-10-03	89-36-49	15.869
合計				倍面積	826.525999	-826.525999			83.356
				面積	413.2629996	413.2629996			